



# morphy richards

**3 Year  
Guarantee\***

\*Upon registering your product  
at [morphyrichards.co.uk](http://morphyrichards.co.uk)

## DUCTLESS Portable Air Conditioner



Model No.  
**824020**

## User Manual

Please read and keep these instructions for future use





## HEALTH AND SAFETY

The use of any electrical appliance requires the following common sense safety rules.

**Please read these instructions carefully before using the product.**

- This appliance can be used by children aged from 8 years and above and persons with reduced physical, sensory or mental capabilities, or lack of experience and knowledge, if they have been given supervision or instruction concerning the use of the appliance in a safe way and understand the hazards involved.
- Children shall not play with the appliance.
- Cleaning and user maintenance shall not be made by children without supervision.
- If the mains cable is damaged, it must be replaced by the manufacturer, it's service agent or similarly qualified person in order to avoid a hazard.
- **WARNING:** Misuse of the appliance could cause personal injury.





## HEALTH AND SAFETY

- Keep the appliance and its cord out of reach of children.
- This appliance is intended for household use only. It is not suitable for use in staff kitchen areas in shops, offices and other commercial environments.
- Except the timer and remote control supplied with the machine, the appliance is not intended to be operated on an extension cable or by means of an external timer or separate remote control on the power supply.
- This device is used in open and semi-open spaces.





## HEALTH AND SAFETY

### LOCATION

- Ensure that the appliance is used on a firm flat surface.
- The appliance should have a minimum distance of 30cm away from walls or other obstructions on all sides to allow for proper air circulation.
- Do not expose the appliance to direct sunlight.
- Do not use the appliance outdoors or near water.
- The appliance should be stood upright during operation and when moving; it should **NEVER** be laid on its side.
- Do not use the appliance next to curtains, clothing, tablecloths, hair or other items that can be drawn into the unit.
- Do not use the appliance near open flames, flammable or explosive gases.

### MAINS CABLE

- Do not let the mains cable run across an open space e.g. between a low socket and a table.
- Do not let the mains cable hang over the edge of the worktop where a child could reach it.
- The mains cable should reach from the socket to the product without straining the connections.
- Do not operate the appliance with a damaged cable.

### PERSONAL SAFETY

- Keep hands, hair and clothing, and utensils away from the appliance while in operation, to prevent personal injury and/or damage to the appliance.
- Do not operate with wet hands.
- In the unlikely event technical problems develop, stop using the product immediately and seek advice from the manufacturer.
- **Do not touch the aluminium fins at the air inlet behind the filter as they may cause injury.**

### OTHER SAFETY CONSIDERATIONS

- The use of attachments or tools not recommended or sold by Morphy Richards may cause fire, electric shock or injury.
- Do not move the product while switched on.
- Do not use this product for anything other than its intended use.
- Unplug from the outlet when not in use.
- **Do not sit or place any objects on top of the product.**
- **Do not use any methods to accelerate the defrosting process or clean the frosted parts.**
- **WARNING: The appliance must not be immersed in water for cleaning.**
- **WARNING: Misuse of this appliance could cause personal injury.**



## ELECTRICAL DETAILS

Check that the voltage on the rating plate of your appliance corresponds with your house electricity supply which must be A.C. (Alternating Current).

Should the fuse in the mains plug require changing, replace it with a fuse of the same rating as originally fitted.

The power consumption in off mode is 0.5w.

The period after which the equipment reaches automatic off mode is 20s.

**WARNING: The plug removed from the mains lead, if severed, must be destroyed, as a plug with a bared flexible cord is hazardous if engaged into a live socket outlet.**

**WARNING: This appliance must be earthed.**





## SAFETY RELATING TO REFRIGERANT R290 (PROPANE)

**Read the entire instruction manual carefully before attempting to use the appliance.**

- This appliance contains the refrigerant R290. R290 is a refrigerant that complies with the relevant European Directives. Never perforate the refrigerant circuit.
- **CAUTION: R290 (propane) is flammable.**
- **DO NOT** store the appliance in a room containing other continuously operating ignition sources (for example: open flames, an operating gas appliance or an operating electric heater).
- **DO NOT** pierce or burn any of the components of the cooling circuit of the unit.
- **DO NOT** set the unit on fire.
- Take care to store the appliance in such a way as to prevent mechanical faults or damage from occurring.
- Be aware that the refrigerant may be odourless, and that leaks may not be detectable by smell.
- **ALWAYS** take care to comply with national gas regulations.
- Keep ventilation openings clear of obstruction.
- Store the appliance in a well-ventilated area where the room size corresponds to the room area specified for operation.
- Any person who is involved with working on or breaking into a refrigerant circuit should hold a current valid certificate from an industry-accredited assessment authority, which authorises their competence to handle refrigerants safely in accordance with an industry recognised assessment specification.
- **WARNING: Do not place the unit on or near a hot gas electric burner.**







R290





## SAFETY RELATING TO REFRIGERANT R290 (PROPANE)

 <b>WARNING</b>	<p>This unit uses a flammable refrigerant. If refrigerant leaks and comes in contact with fire or heating part, it will create harmful gas and there is risk of fire.</p>
	<p>Read the <b>USER MANUAL</b> carefully before operation.</p>
	<p>Further information is available in the <b>USER MANUAL</b>, <b>SERVICE MANUAL</b>, and the like.</p>
	<p>Service personnel are required to carefully read the <b>USER MANUAL</b> and <b>SERVICE MANUAL</b> before operation.</p>

- **The refrigerant loop is sealed. Only a qualified technician should attempt to service!**
- Do not discharge the refrigerant into the atmosphere.
- R-290 (propane) is flammable and heavier than air.
- It collects first in low areas but can be circulated by the fans.
- If propane gas is present or even suspected, do not allow untrained personnel to attempt to find the cause.
- If a leak is detected, immediately evacuate all persons from the area, ventilate the room and contact the local fire department to advise them that a propane leak has occurred.
- Do not let any persons back into the room until the qualified service technician has arrived and that technician advises that it is safe to return to the room.
- No open flames, cigarettes or other possible sources of ignition should be used inside or in the vicinity of the units.
- Component parts are designed for propane and non-incentive and non-sparking. Component parts shall only be replaced with identical repair parts.
- **WARNING: Failure to abide by this warning could result in an explosion, death, injury and property damage.**



## PRODUCT OVERVIEW

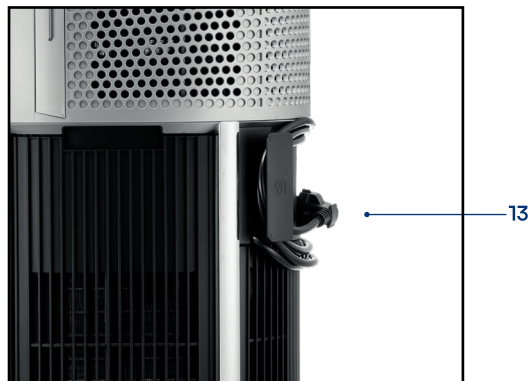
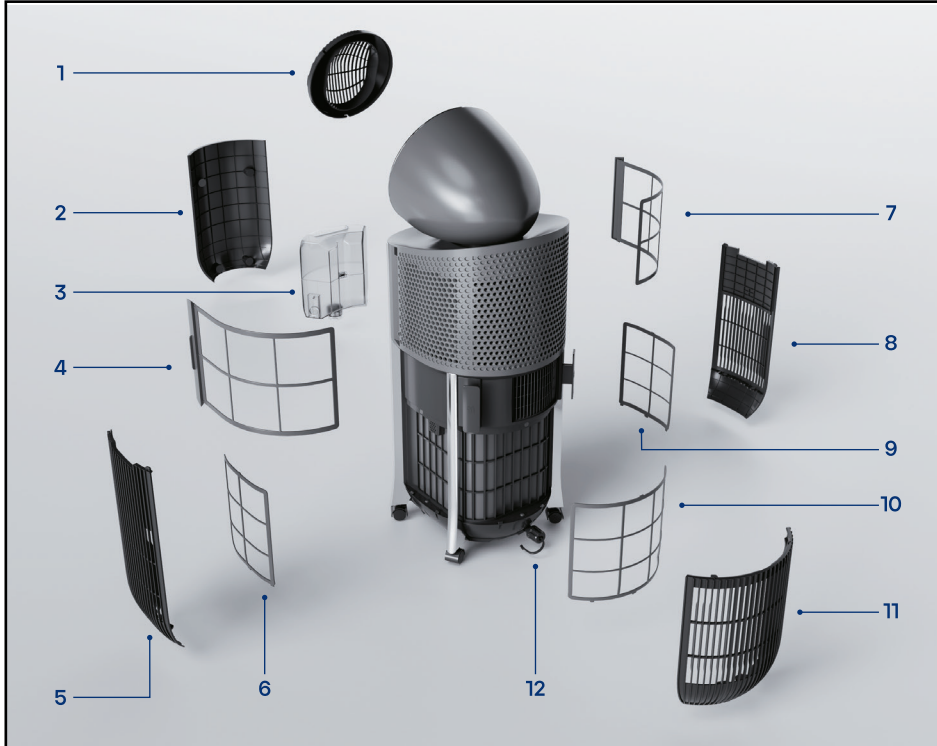



## PRODUCT OVERVIEW

### CONTROL PANEL

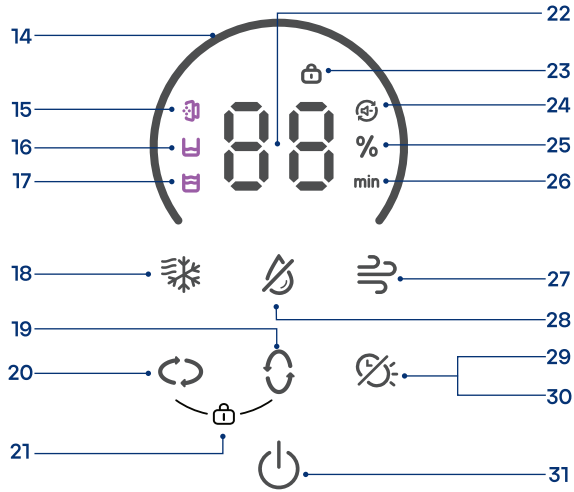

### REMOTE CONTROL

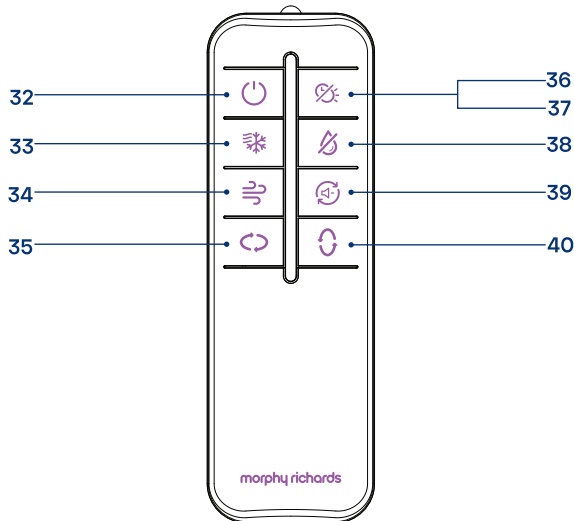



## PRODUCT OVERVIEW

1. Air outlet grille
2. Front grille
3. Water tank
4. Right side upper filter
5. Right side grille
6. Right side filter
7. Left side upper filter
8. Left side grille
9. Left side filter
10. Back filter
11. Back grille
12. Water outlet
13. Power cable
14. Fan speed/level
15. Filter cleaning indicator
16. Water shortage. Lights up red in AC mode
17. Full Water. Lights up red in dry mode
18. Air-conditioning mode
19. Vertical swing
20. Horizontal swing
21. Child lock: Press together
22. Digital tube. Fan speed/humidity/prompt code
23. Child lock indicator
24. Longlasting comfort mode. Lights up in AC mode
25. Unit of humidity indicator. Lights up in dry mode
26. Unit of time indicator. Lights up in timing function
27. Fan mode
28. Dry mode
29. Timing: Touch press
30. Light: Press and hold
31. Power on/off button
32. Remote control power on/off button
33. Remote control air-conditioning mode
34. Remote control fan mode
35. Remote control horizontal swing
36. Remote control timing: Touch press
37. Remote control light: Press and hold
38. Remote control dry mode
39. Remote control longlasting comfort mode
40. Remote control vertical swing



## BEFORE FIRST USE

- If the product has been tipped more than 45°, allow the unit to stand upright for at least 24 hours before switching on
- Remove all packaging and check that the remote control and all removable parts are packed with the product.
- Insert 2 x AAA batteries in the remote control (not supplied).

## LOCATION

- The appliance should not be located in a damp environment or in direct sun light.
- Place on a firm, level surface.
- Keep upright when moving the appliance.
- Do not install the machine in a room with open flames (such as lit gas appliances) or ignition sources (such as working electric heaters).
- Ensure that the appliance is at least 30cm around the away from walls, furniture or curtains.

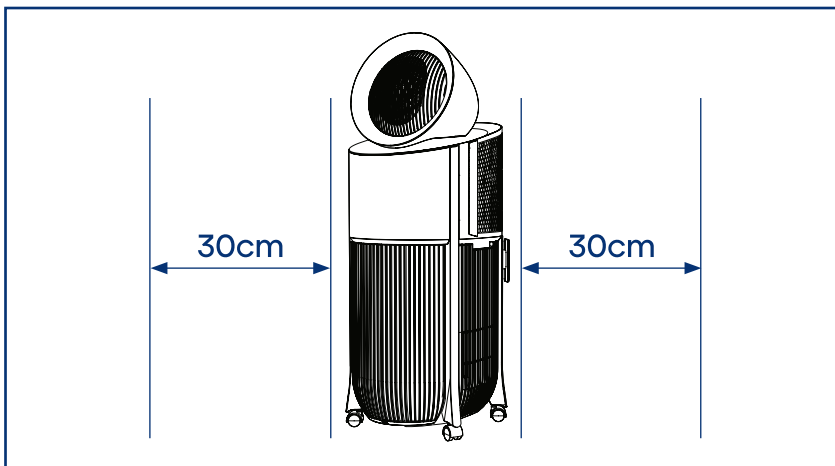

## USING YOUR AIR CONDITIONING UNIT

- Connect the plug (10) to a mains outlet.
- The appliance will automatically power on. All LED's on the control panel will light up for 1 second and a buzzing sound will be heard.
- Press the "Power" button (31) to turn the machine on.

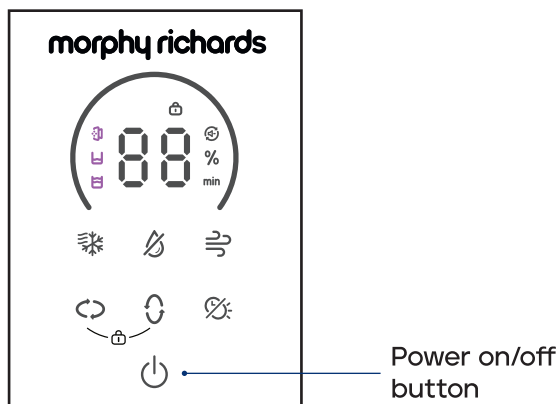

### Notes:

- When the appliance is turned on for the first time, it will enter AC (air conditioning) mode (18)-SP fan speed by default.
- The appliance has a memory function, and will automatically enter the mode used before the last shutdown when turning it on.
- Press the "power" button (31) again to turn it off. All lights will go out, and the air outlet will automatically return to the initial position. There is a delay of approx. 20 seconds before the fan turns off.
- After powering off the appliance, please keep the appliance still for at least 5 minutes before removing the water tank (3), in case there are still some water drops.



## USING YOUR AIR CONDITIONING UNIT

- Before choosing AC mode, please check that the water tank is full of water.
- Pull down to remove the front grille (2).

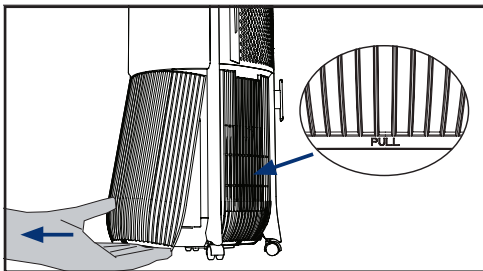

- Pull out the water tank (3) and fill to the maximum level.
- Please ensure that you do not exceed the MAX line when adding water.

**Note:** In AC mode (18), when the water tank is short of water, the water shortage icon (16) will light up, on the control panel prompting you to add clean water to the tank.

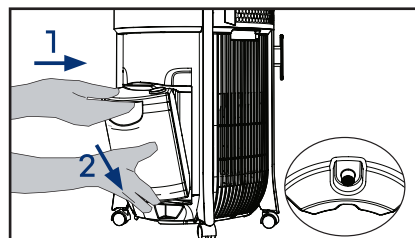
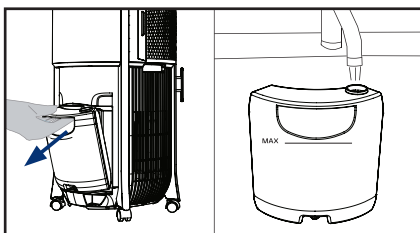

- Align the water tank outlet with the notch at the bottom of the machine and insert the water tank.





## USING YOUR AIR CONDITIONING UNIT

- Refit the front grille (2).

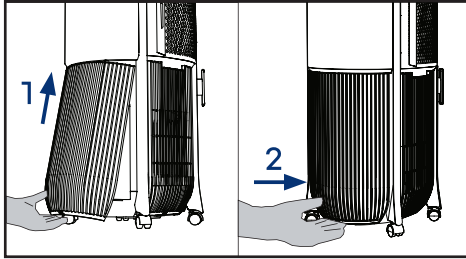

- Press the Power on/off button (31).
- Press the "AC" button (18) to start the appliance.
- Then press the "AC" button (18) to adjust the fan speed.

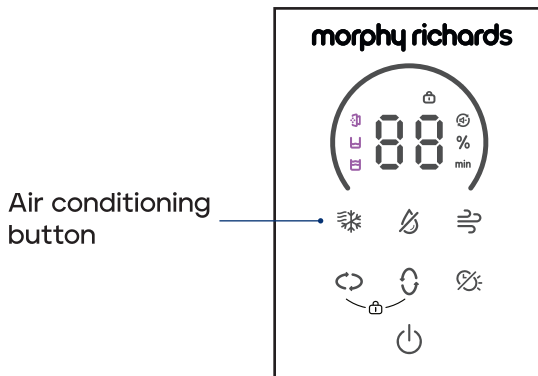

### Notes:

There are 4 fan speeds: Low("LO") - High("HI") - Super("SP") - Long lasting comfort (24) (when this mode activates, the icon will light up and the other icons extinguish).





## USING YOUR AIR CONDITIONING UNIT

### DEHUMIDIFYING MODE

Before choosing dehumidifying mode (25) check the water tank (3) is empty.

- Pull down to remove the front grille (2).

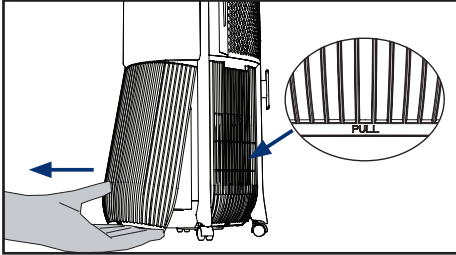

- Pull out the water tank and empty any water in the tank.

**Note:** In dehumidifying mode (25) when the tank is full of water, the full water icon (17) will light up, the control panel will display the alarm, prompting you to empty the water tank.

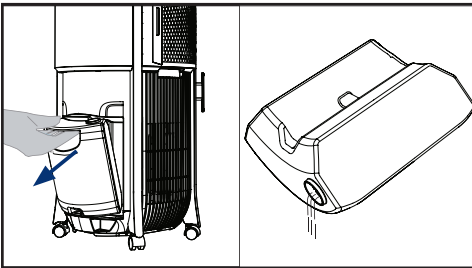

- Align the water tank outlet with the notch at the bottom of the machine and refit the water tank (3).

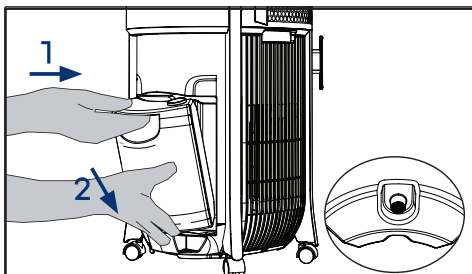



## USING YOUR AIR CONDITIONING UNIT

- Refit the front grille (2).

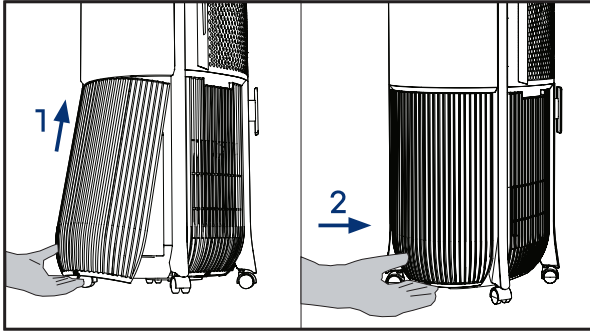

- Press the Power on/off button (31).
- Press the "dry" button (28) to start the appliance.
- The display panel will show the real-time humidity in the room.
- The fan speed (14) is fixed at "Lo" and cannot be changed.

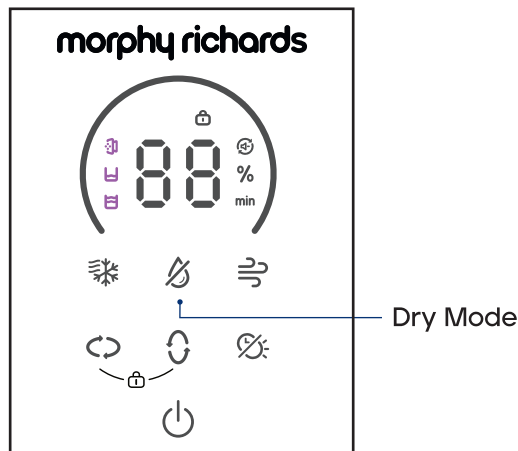



## USING YOUR AIR CONDITIONING UNIT

### FAN MODE

- Press the Power on/off button (31).
- Press the "fan" button (27) to start fan mode.
- The fan speed is "SP"(Super) by default.
- When it is in fanning mode, press "fan" (27) button to adjust the fan speed. There are 3 fan speeds options: Low("LO") - High("HI") - Super("SP").

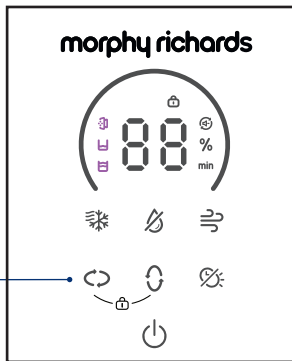

Horizontal swing  
and vertical swing

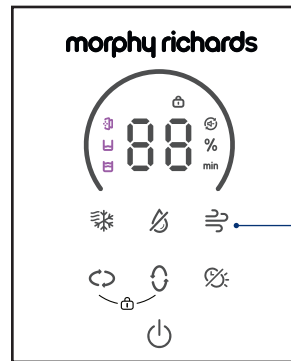

Fan Mode

### FAN SWING

In any mode of air-conditioning (18) dehumidifying (25) and fan (27).

- Press the "horizontal swing" button (20). The air outlet will swing left and right within a 50° angle.
- Press the "vertical swing" button (19). The air outlet will swing up and down within a 50° angle.



## USING YOUR AIR CONDITIONING UNIT

### TIMER AND LIGHT

In any mode of AC (18) dry (28) and fan (27), press the "Timer/Light" button (29/30) to activate the timer function.

- Each press will increase the time by 10 minutes.

**Note:** The time range is 10mins - 90mins.

- After setting the time, wait for 3 seconds and the time on the control panel will flash, indicating that setting the time is successful.
- If you want to cancel the timer, press the timer/light button (29/30) and set the time to "00min" and wait for 3 seconds.

In any mode, to turn the atmosphere light on or off, press and hold the "Time/Light" button.

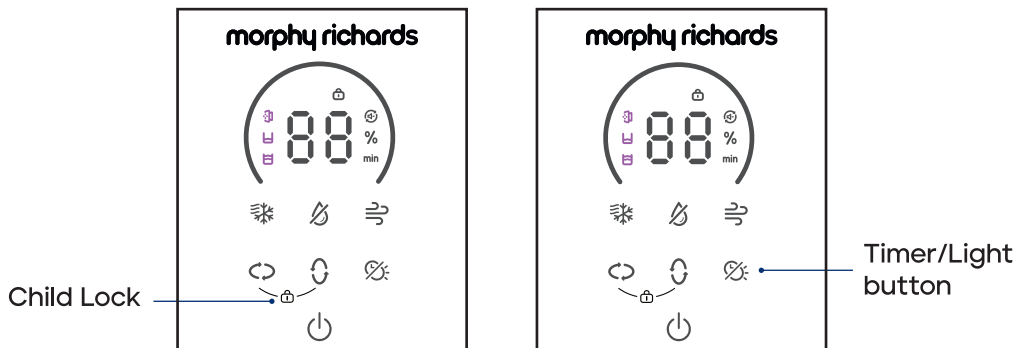

### CHILD LOCK

When the machine is powered on or any mode, the child lock can be set as follows:

- To activate the child lock, press the "Horizontal swing" button (19) and "Vertical swing" button (20) at the same time for a few seconds.





## CARE & CLEANING

**WARNING:** Before cleaning, the appliance **MUST** be switched off and the plug disconnected from the mains outlet.

- Except for the removeable grilles, filters and water tank, **DO NOT** attempt to disassemble, clean, repair or modify any other internal parts.
- Wipe the main unit with a damp cloth. Do not use any abrasive or solvent-based cleaner.
- Wipe the main unit with a damp cloth. Do not use any abrasive or solvent-based cleaner.

### CLEANING THE FILTER SCREENS

- Follow the procedure below to disassemble the filter screens.
- Remove the filter screens from the left (7) and right upper sides (4).

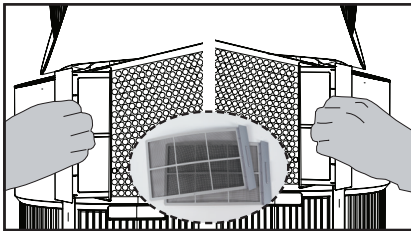

- Remove the grilles from the left (8) and right (5) hand sides.

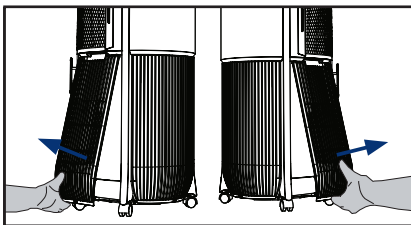



## CARE & CLEANING

- Remove the left (9) and right (6) filters from the side grilles.

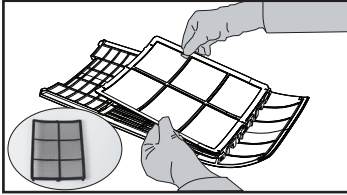

- Remove the back grille (12) and detach the filter screen (11).

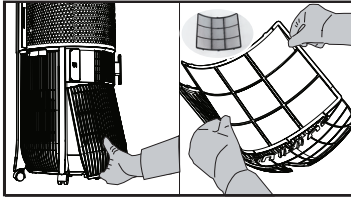

- After disassembling the filter screens, remove dust with a soft brush or cloth and rinse with clean water.
- Dry with a towel or place in a ventilated place. Ensure they are thoroughly dried before refitting.

## DRAINING WASTEWATER

- Before storing the appliance, drain any wastewater from the appliance.
- Position a container under the water outlet (13) to collect water or move the appliance drain directly into a waste water drain.
- Unscrew the drain cap and gently pull out the rubber plug.
- Allow to drain fully, then replace the rubber plug securely.

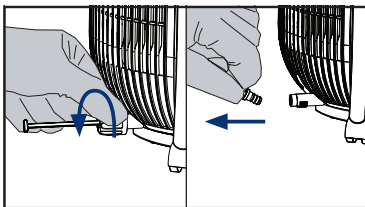



## TROUBLESHOOTING

Problem	Possible Cause	Solution
No power / not turning on.	Is the power connected?	Check the fuse. Try a new fuse with the same rating.
		Try a different appliance in the socket as it may be the socket that is at fault.
The appliance isn't working to full capacity.	Room temperature is too high/low.	The operating temperature range is 16 - 40°C.
	Dirty filters.	Clean the filters following instructions supplied in this manual.
	Obstruction to the air flow.	Ensure that the appliance is at least 30cm away from walls, furniture or curtains on all sides.
	Has the desired operating mode and temperature been selected?	Check the mode and temperature are set correctly.
Fan speed will not adjust.		Unplug the appliance, reconnect and restart the appliance.
Fan swing not working.		Unplug the appliance, reconnect and restart the appliance.
Water leakage.	Overflows while moving the appliance.	Empty the water tank before transporting.
	Water tank is full but the float is stuck, so the appliance can't feed back the water tank status.	Pull down the front grille to check if the float in water tank is stuck.
	Water tank could be cracked/ damaged.	Pull down the front grille to check if water tank is cracked.
Shuts down suddenly.	A shutdown time is set and the time has run its course.	Restart the appliance.



## TROUBLESHOOTING

Problem	Possible Cause	Solution
Excess noise.	Is the appliance positioned correctly?	Ensure the appliance is stood on a firm, flat surface to reduce noise and vibration.
	Noise sounds like running water.	This sound is a normal phenomenon that water is running to cool the exhaust.
Water droplets are forming on the appliance.	When operating in high humidity environments, water droplets may form at the air vents, panels, and other areas.	This is normal.
	Long term cooling operation in an open space will produce water droplets.	This is normal.
	Low fan speed may lead to the formation of water droplets.	Increase the fan speed.
Water mist blown from appliance.	The air conditioner is cooling when the ambient humidity is high, the air outlet may blow out water mist.	This is normal.
Odours coming from the appliance.	The appliance may have absorbed the odours, fumes, dust, cigarette smoke etc and emit strange odours during operation.	Please refer to cleaning the filter screens.
Remote Control Not Working.	Lost Pairing Link.	Power on the machine, point the remote at the main unit's control panel, then press and hold the remote control's power button for 5 seconds, until you hear a "ding-ding" beep sound, indicating the pairing is complete.
	Battery Depleted.	Change Batteries.





## TROUBLESHOOTING

### ERROR CODES

#### [Water shortage icon] Reminder Water Tank Needs Water Adding

The water shortage icon (16) turns red on the control panel of appliance, indicating that the water tank is short of water in air-conditioning mode.

- Add water to water tank (3).
- The float is stuck. Release the float by gently shaking or tapping the tank.

#### [Water full icon] Reminder Water Tank is Full

The water full icon (16) turns red on display panel of machine, indicating that the water tank is full of water in DRY mode.

- Empty the water tank (3).
- The float is stuck. Release the float by gently shaking or tapping the tank.

#### [P3] Outside Operating Temperature Range

Error code [P3] appears on the control panel of the appliance, indicating that the current ambient temperature has been detected outside the operating temperature range of 16 °C - 40 °C for 60 seconds in the AC (18) and DRY mode (28).

#### [E8] Water Tray is Full

Error code [E8] appears on display panel of machine, indicating that the water tray has been detected full for 5 seconds in all modes.

- Please follow the procedure for draining wastewater.

#### [Filter cleaning icon] Reminder that the Filters Are Dirty

The filter cleaning icon (15) turns red on the control panel of the appliance, indicating that the machine has been run for more than 250 hours and the filter screens should be cleaned.

- Please refer to Cleaning the Filter Screens.
- Press and hold the "dry" button (29/30) for 3 seconds, the indicator light will go out.

#### Other Error Codes: [E1] [E2] [E3] [E6] [E7]

When error code [E1], [E2], [E3], [E6], [E7] appears on the control panel. Disconnect the plug, reconnect and restart the machine.

If the error code doesn't disappear, please contact Customer Service.







## SPARE PARTS

Part Number	Description	Qty per Product	Key Number
33011	Right side upper filter	1	4
33012	Left side upper filter	1	7
33013	Water tank	1	3
33014	Right side lower filter	1	5
33015	Left side lower filter	1	9
33016	Window kit slide bar	1	10
33017	Back filter	1	2
33018	Front grille	1	6
33019	Back grille	1	11
33020	Left side grille	1	8
33021	Air outlet grille	1	1
33022	Remote control	1	N/A





## SAFETY PRECAUTIONS ON SERVICING

 <b>WARNING</b>	<p>Any person who is involved with working on or breaking into a refrigerant circuit should hold a current valid certificate from an industry-accredited assessment authority, which authorizes their competence to handle refrigerants safely in accordance with an industry, recognized assessment specification.</p>
 <b>WARNING</b>	<p>Servicing shall only be performed as recommended by the equipment manufacturer. Maintenance and repair requiring the assistance of other skilled personnel shall be carried out under the supervision of the person competent in the use of flammable refrigerants.</p>

Please follow these warnings when to undertake the following when servicing an appliance with R290.

### 1. Checks to the area

Prior to beginning work on systems containing flammable refrigerants, safety checks are necessary to ensure that the risk of ignition is minimized. For repair to the refrigerating system, the following precautions shall be complied with prior to conducting work on the system.

### 2. Work procedure

Work shall be undertaken under a controlled procedure so as to minimize the risk of a flammable gas or vapor being present while the work is being performed.

### 3. General work area

All maintenance staff and others working in the local area shall be instructed on the nature of work being carried out. Work in confined spaces shall be avoided. The area around the work space shall be sectioned off. Ensure that the conditions within the area have been made safe by control of flammable material.



## SAFETY PRECAUTIONS ON SERVICING

### 4. Checking for presence of refrigerant

The area shall be checked with an appropriate refrigerant detector prior to and during work, to ensure the technician is aware of potentially flammable atmospheres. Ensure that the leak detection equipment being used is suitable for use with flammable refrigerants, i.e. no sparking, adequately sealed or intrinsically safe.

### 5. Presence of fire extinguisher

If any hot work is to be conducted on the refrigeration equipment or any associated parts, appropriate fire extinguishing equipment shall be available to hand. Have a dry powder or CO<sub>2</sub> fire extinguisher adjacent to the charging area.

### 6. No ignition sources

No person carrying out work in relation to a refrigeration system which involves exposing any pipe work that contains or has contained flammable refrigerant shall use any sources of ignition in such a manner that it may lead to the risk of fire or explosion. All possible ignition sources, including cigarette smoking, should be kept sufficiently far away from the site of installation, repairing, removing and disposal, during which flammable refrigerant can possibly be released to the surrounding space. Prior to work taking place, the area around the equipment is to be surveyed to make sure that there are no flammable hazards or ignition risks. "No Smoking" signs shall be displayed.

### 7. Ventilated area

Ensure that the area is in the open or that it is adequately ventilated before breaking into the system or conducting any hot work. A degree of ventilation shall continue during the period that the work is carried out. The ventilation should safely disperse any released refrigerant and preferably expel it externally into the atmosphere.

### 8. Checks to the refrigeration equipment

Where electrical components are being changed, they shall be fit for the purpose and to the correct specification. At all times the manufacturer's maintenance and service guidelines shall be followed. If in doubt consult the manufacturer's technical department for assistance.





## SAFETY PRECAUTIONS ON SERVICING

The following checks shall be applied to installations using flammable refrigerants:

- The charge size is in accordance with the room size within which the refrigerant containing parts are installed.
- The ventilation machinery and outlets are operating adequately and are not obstructed.
- If an indirect refrigerating circuit is being used, the secondary circuit shall be checked for the presence of refrigerant.
- Marking to the equipment continues to be visible and legible. Markings and signs that are illegible shall be corrected.
- Refrigeration pipe or components are installed in a position where they are unlikely to be exposed to any substance which may corrode refrigerant containing components, unless the components are constructed of materials which are inherently resistant to being corroded or are suitably protected against being so corroded.

### 9. Checks to electrical devices

Repair and maintenance to electrical components shall include initial safety checks and component inspection procedures. If a fault exists that could compromise safety, then no electrical supply shall be connected to the circuit until it is satisfactorily dealt with. If the fault cannot be corrected immediately but it is necessary to continue operation, an adequate temporary solution shall be used. This shall be reported to the owner of the equipment so all parties are advised.

Initial safety checks shall include:

- Those capacitors are discharged: this shall be done in a safe manner to avoid possibility of sparking.
- That there no live electrical components and wiring are exposed while charging, recovering or purging the system.
- That there is continuity of earth bonding.

**WARNING: Install the unit in rooms which exceed 10 m<sup>2</sup>. Do not install the unit in a place where inflammable gas may leak.**



## CONTACT US

If you are having a problem with your appliance, please contact our Helpline, as we are more likely to be able to help than the store you purchased the item from. Please have the product name, model number and serial number to hand when you contact us to help us deal with your enquiry quicker.

email: [hello@morphyrichards.co.uk](mailto:hello@morphyrichards.co.uk)

[www.morphyrichards.co.uk](http://www.morphyrichards.co.uk)

## PRODUCT RECYCLING



For electrical products sold within the European Community, at the end of the electrical products useful life, it should not be disposed of with household waste.

Please recycle where facilities exist.

Check with your Local Authority or retailer for recycling advice in your country.







## REGISTERING YOUR 3 YEAR GUARANTEE

Your standard 2 year guarantee is extended for an additional 1 year when you register the product within 28 days of purchase with Morphy Richards. If you do not register the product with Morphy Richards within 28 days, your product is guaranteed for 2 years.



To validate your 3 year guarantee, scan the QR code or register online at [www.morphyrichards.co.uk](http://www.morphyrichards.co.uk)

N.B. Each qualifying product needs to be registered with Morphy Richards individually. Please note that the 2 year guarantee is only available in the UK. Please refer to the 2 year guarantee for more information.

### YOUR 2 YEAR GUARANTEE

It is important to retain the retailer's receipt as proof of purchase. Staple your receipt to the back cover for future reference.

Please quote the following information if the product develops a fault. These numbers can be found on the base of the product.

**Model no.**

**Serial no.**

All Morphy Richards products are individually tested before leaving the factory. In the unlikely event of any appliance proving to be faulty within 28 days of purchase, it should be returned to the place of purchase for it to be replaced. If the fault develops after 28 days and within 24 months of original purchase, you should contact the Helpline quoting Model number and Serial number on the product, or write to Morphy Richards at the address shown. You may be asked to return a copy of proof of purchase.

Subject to the exclusions set out on the next page (see Exclusions), the faulty appliance will then be repaired or replaced as appropriate and dispatched usually within 7 working days of receipt.

If, for any reason, this item is replaced or repaired during the 2 year





## REGISTERING YOUR 3 YEAR GUARANTEE

guarantee period, the guarantee on the new item will be calculated from the original purchase date. Therefore it is vital to retain your original till receipt or invoice to indicate the date of initial purchase.

To qualify for the 2 year guarantee, the appliance must have been used according to the instructions supplied.

The appliance is intended for domestic use only. Misuse or use for commercial or any other purpose will render the guarantee invalid.

### Exclusions

Morphy Richards shall not be liable to replace or repair the goods under the terms of the guarantee where:

1. The fault has been caused or is attributable to accidental use, misuse, negligent use or used contrary to the manufacturer's recommendations or where the fault has been caused by power surges or damage caused in transit.
2. The appliance has been used on a voltage supply other than that stamped on the products.
3. Repairs have been attempted by persons other than our service staff (or authorised dealer).
4. The appliance has been used for hire purposes or non domestic use.
5. The appliance is second hand or refurbished.
6. Morphy Richards reserves the right not to carry out any type of servicing under the guarantee at its discretion.

This guarantee does not confer any rights other than those expressly set out above and does not cover any claims for consequential loss or damage. This guarantee is offered as an additional benefit and does not affect your statutory rights as a consumer. Morphy Richards products are intended for household use only. See usage limitations within the location safety instructions.

### Disclaimer

Morphy Richards has a policy of continuous improvement in product quality and design. The company, therefore reserves the right to change the specification of its models at any time.



AT824020MUK Rev1

# morphy richards



@morphyrichardsuk #loveyourmorphy

[morphyrichards.co.uk](http://morphyrichards.co.uk)

**Morphy Richards**  
9 Cabot Lane, Poole, Dorset, BH17 7BY, UK

